



Tower 5 MahaRERA No.
P51800054164



Tower 6 MahaRERA No.
P51800079254
www.maharera.mahaonline.gov.in



THE FINAL TOWER IN MULUND'S *Private Paradise.*

LAUNCHING

Rayansh

AT VANA - PIRAMAL REVANTA



Piramal
revanta
MULUND





Artistic Impression

MULUND'S MOST *iconic* ADDRESS.

A thoughtfully planned community that has always stayed in tune with nature, Piramal Revanta offers a vibrant lifestyle straight out of your dreams. With over 50+ amenities, two clubhouses and greenspaces as far as the eye can see, it is a close-knit neighbourhood fostering love and connection.



A Luxury 12-acre Integrated Township in the Heart of Mulund



Overlooking ~25,000 acres of Sanjay Gandhi National Park



At the Intersection of LBS Marg, Marathon Avenue & Proposed GMLR



Skyscrapers Up to 48 Storeys



Up to 30% Open Green Spaces



Phase 1 Clubhouse & Podium Top Amenities Delivered



WHERE *neighbours* TURN INTO EXTENDED *family*.

Every skyline needs a soul. At Piramal Revanta, it's the people who give it one. Over 700 families now call this place home. What began as a bold vision has become a neighbourhood full of warmth, laughter and rhythm.

It's in the morning jogs, evening swims, the festivals that light up every floor. It's in the simple hello that turns into a conversation. This is a place where the community is full of life and light and that makes all the difference.



LIFE IN ITS *finest* FORM.

50+ amenities spread across ~5.84 acres, each one designed to enrich your experience.

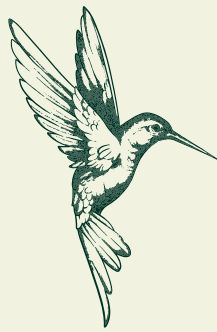

GROUND LEVEL AMENITIES

This is where life slows down. Green lawns meant for sun-kissed days, paths carved for barefoot mornings and a play area that reminds us of what childhood felt like.

PODIUM TOP AMENITIES

A level above, this is where the noise gives way to quiet rituals. Evenings stretch longer here - over a match, a chat or just that soft pause before the world picks up again.

CLUB RASA & CLUB RAHA

Two clubhouses. One soul. Club RASA rejuvenates and Club RAHA restores. Think early morning workout, late night movie at the mini theatre, stolen hours in-between, made to amplify your life.



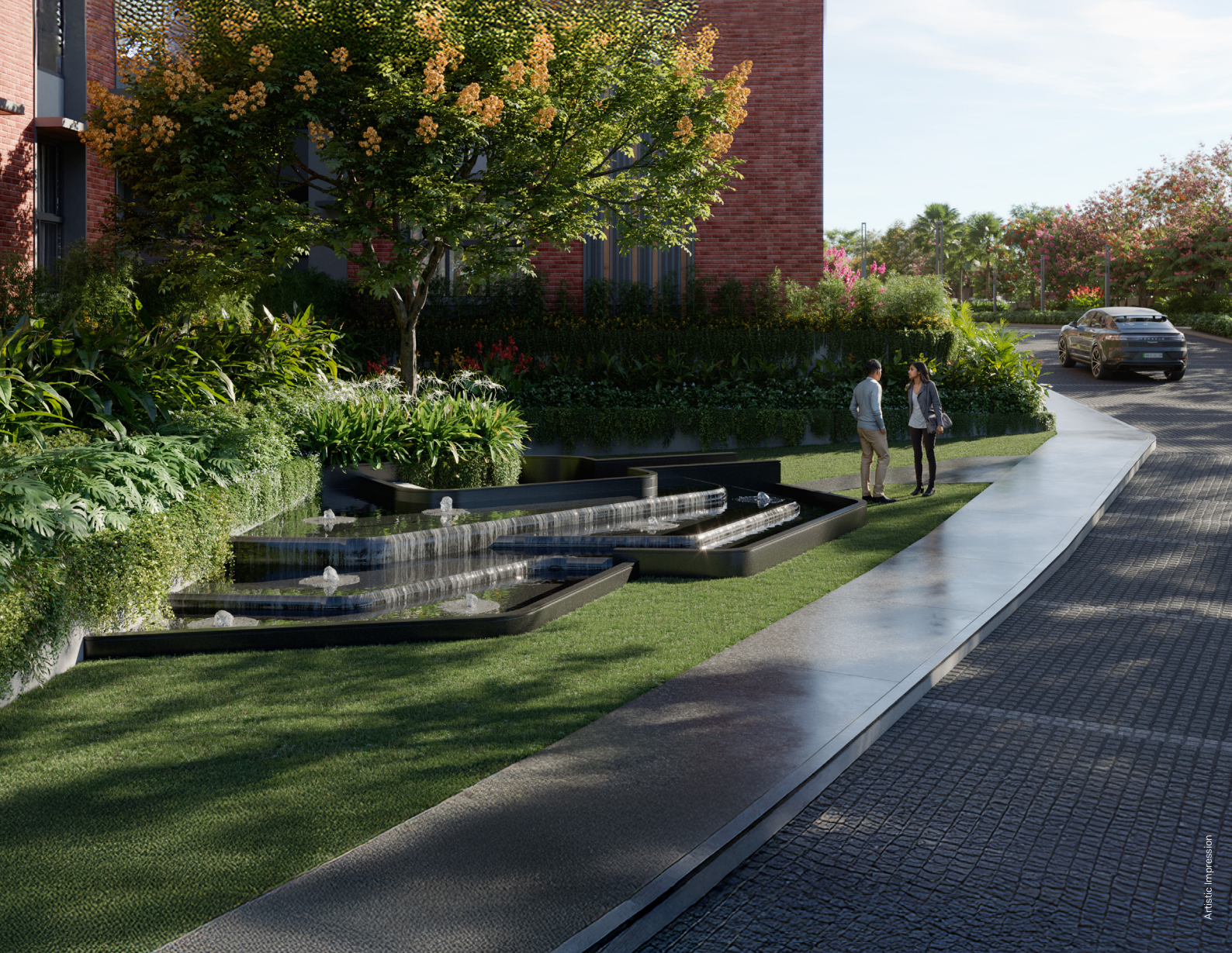



Artistic Impression

GROUND LEVEL AMENITIES

 Jogging and Cycling Track

 Meditation Deck

 Multipurpose Play Court

 Walking Loop

 Yoga Garden

 Tree House

 Kids' Play Area

 Outdoor Gym

 Skating Rink

 Pet Park

 Cabana Deck

 Hammock Garden

 Water Cove

 Central Spine

 Tree Grove Plaza

 Croquet Lawn

 Entry Portal

 Green Plaza

 Focal Point

 Seating Court

 Trampoline Cove

 Transition Green Plaza

 Driveway

 Happy Street



TREE GROVE PLAZA

Artistic Impression



SKATING RINK

Artistic Impression



PET PARK

Artistic Impression



Artistic Impression

PODIUM TOP AMENITIES



Swimming Pool



Kids' Play Area



Play Lawn



Meditation Zone



Toddlers' Play Area



Free Play Lawn



Amphitheatre



Kids' Pool



Butterfly Garden



Infinity Pool



Pool Side Deck



Stepped Plaza



Cabanas



Work Deck



Viewing Gallery



Senior Citizen Area



Senior Seating Area



Sky Lounge



Walking Pathway



Multipurpose Court



Swing Corner



THE *luxury* OF LETTING GO.

Club RASA - Rejuvenation And Sports Arena is a statement in its own, delivered and ready to use. Built across ~20,000 sq.ft., this is where quiet mornings melt into spirited evenings, every corner invites indulgence and leisure finds its truest expression.

Shot on Location

CLUB RASA AMENITIES



Café



Gymnasium



Spa



Games Zone



Library



Squash Court



Fitness Studio



Multisport Court



MULTISPORT COURT

Shot on Location



CAFÉ

Shot on Location



GYMNASIUM

Shot on Location



CLUB
raha

RELAX • ALIGN • HEAL • ACHIEVE

THE ART OF *wellness*, MASTERED.

Strategically stitched between Towers 5 and 6, Club RAHA - **Relax. Align. Heal. Achieve.** Spanning across ~10,000 sq.ft., it is more than just walls and windows, its a space to luxuriate in where every moment lingers just a little longer.

Artistic Impression

CLUB RAHA AMENITIES



Ballroom



Gymnasium



Crèche



Games Zone



Mini Theatre



Fitness Studio



Salon



First Aid Room



GAMES ZONE



MINI THEATRE



SALON



Vana

AT PIRAMAL REVANTA

MULUND'S OWN *Private Paradise.*



Vana is an expansive 3-acre land parcel with just 2 towers, set within the extensive 12-acre ecosystem of Piramal Revanta. With Tower 5 (Raynav) standing tall at 37 storeys and Tower 6 being the tallest in the development, Vana is nature's cocoon, enveloped in luxury.





Artistic Impression

WHERE *nature* TAKES CENTRE STAGE.

A place where mornings begin with fresh air and quiet strolls, afternoons drift by in sunlit pools and evenings find their rhythm in the warmth of shared moments.
Where amenities aren't just features, they're moments full of love and life.

VANA HIGHLIGHTS



3-Acre Green
Paradise with
Only Two Towers



~12,500 sq.ft.
Lobby Drop-
Off Experience



Over 60%
Open
Spaces



3 Level Clubhouse
with Lifestyle
Amenities



LAUNCHING THE FINAL TOWER IN MULUND'S *Private Paradise*.

Introducing Rayansh, Tower 6 at Piramal Revanta, designed to elevate every moment and embrace a life full of light, luxury and tranquillity.



Rayansh

AT VANA - PIRAMAL REVANTA



Last chance TO OWN THE
BEST OF MULUND.

— RAYANSH HIGHLIGHTS —



Tallest Tower
in Piramal Revanta,
Soaring 48 Floors High



Sanjay Gandhi National
Park & Mulund City
Skyline Views



Grand
Double Heighted
Entrance Lobby



Tower is
East-West
Oriented



The art OF ARCHITECTURE, IN EVERY DETAIL.

RAYANSH APARTMENT HIGHLIGHTS



Vastu Compliant
Residences



All Residences
with Private Decks



Sanjay Gandhi National Park
or Mulund City Skyline Views



Floor-to-beam Bottom
Windows in Living Room



Flexibility to Combine
Residences to Form Jodis



3.1 m Floor to
Floor Height